

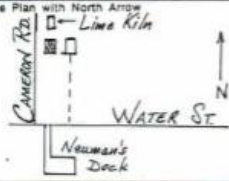

OHIO HISTORIC INVENTORY

1. No. ERI-1531	4. Present Name(s) Michael Feyedelem	1. No. ERI-1531
2. County ERIE	5. Other Name(s)	2. County erie
3. Location of Negatives O.H.S.	Norman Kelley & Co.; KIL&T Co. Worker's House	4. Present Name(s) Michael Feyedelem Residence
6. Specific Location First house on east side of Cameron Rd., north of Water St.	18. Thematic Category Manufacturing, ethnic	28. No. of Stories 1 1/2
7. City or Town If Rural, Township & Vicinity Kelleys Island, Ohio	17. Date(s) or Period c. 1873	29. Basement? Yes <input type="checkbox"/> No <input checked="" type="checkbox"/>
8. Site Plan with North Arrow 	19. Architect or Engineer N/A	30. Foundation Material Limestone rubble
9. U.T.M. Reference 17 356280 46063110	20. Contractor or Builder N/A	31. Wall Construction Wood frame
Zone 0. Site <input type="checkbox"/> Structure <input type="checkbox"/> Building <input checked="" type="checkbox"/> Object <input type="checkbox"/>	21. Original Use, if apparent Company house	32. Roof Type & Material Gable/asph. shingle
11. On National Register? Yes <input type="checkbox"/> No <input checked="" type="checkbox"/>	22. Present Use Residence	33. No. of Bays Side
12. Is it Eligible? Yes <input type="checkbox"/> No <input checked="" type="checkbox"/>	23. Ownership Public <input type="checkbox"/> Private <input checked="" type="checkbox"/>	34. Wall Treatment Board & batten
13. Part of Estab. Yes <input type="checkbox"/> No <input checked="" type="checkbox"/>	24. Owner's Name & Address, if known Michael Feyedelem	35. Plan Shape Rectangle
14. District Potent? Yes <input type="checkbox"/> No <input checked="" type="checkbox"/>	25. Open to Public? Yes <input type="checkbox"/> No <input checked="" type="checkbox"/>	36. Changes (Explain in #42) Exterior Fair
15. Name of Established District N/A	26. Local Contact Person or Organization Kevin Fape: K.I. Hist. Survey	37. Condition Interior Fair
42. Further Description of Important Features This building is identical to ERI-1709-11. It is a shotgun style house with a central-ridge, brick chimney and a side-gabled roof. Flush doorways are found in the center of the eastern eave wall and in the south wall of a long, narrow alcove that is covered by a continuous shed roof. Access to the doors is made across a concrete stoop. Windows include 6/6 double hung and	27. Other Surveys in Which Included N/A	38. Preservation Underway? Yes <input type="checkbox"/> No <input checked="" type="checkbox"/>
43. History and Significance This is one of four, extant, identical company houses built for immigrant laborers in the Norman Kelley and Co. quarry. The other three (ERI-1709-11) are located east of this structure, and are arranged linearly along a small lane that provided access to other company houses. This house may have been moved to its present location from that cluster. The	44. Description of Environment and Outbuildings This company house was part of a large complex of houses and quarry-related facilities that initially composed the N. Kelley quarry, and later the KIL&T Co. south quarry (ER-338). It is located just west of another	39. Endangered? Yes <input type="checkbox"/> No <input checked="" type="checkbox"/> By What?
45. Sources of Information Sandusky Register, June 1873 1877 Map, U.S. Coastal Survey Oral History: Jos. Feyedelem Elmer Kraft E. Bonchi	46. Prepared by Kevin Fape	40. Visible from Public Road? Yes <input type="checkbox"/> No <input checked="" type="checkbox"/>
	47. Organization K.I. Planning Comm.	41. Distance from and Frontage on Road .77A
	48. Date 10/85	49. Revision Date(s)



5. Other Name(s)
Kelley & Co./KIL&T Co. Worker's House

<p>50. House Type No. Code No. Name _____</p> <p>51. Historic Outbuildings and Dependencies Barn Type(s) Code No. Type _____ _____ _____</p> <p>Corn Crib or Shed <input type="checkbox"/> Smoke House <input type="checkbox"/> Privy <input type="checkbox"/> Silo <input type="checkbox"/> Spring House <input type="checkbox"/> Carriage House <input type="checkbox"/> Summer Kitchen <input type="checkbox"/> or Ice House</p> <p>Other _____</p> <p>52. Archeological Site on Property? Yes <input type="checkbox"/> No <input type="checkbox"/></p> <p style="text-align: center;">Basis for Information</p> <p>Owner Collection <input type="checkbox"/> Above Ground Earthworks or Mound <input type="checkbox"/> Cultural Materials Noted <input type="checkbox"/> OAI No. _____</p>	<p>53. Farmstead Plan</p> <div style="border: 1px solid black; height: 150px; width: 100%; position: relative;"> N E </div> <p>54. Photo Roll No. <u>29</u> Picture No(s). <u>36</u></p>
--	--

42. (Cont'd)

6 light single sash and small square attic window under the gable. Windows are set in simple frames. Trim consists of a narrow frieze band under the gable eaves.

43. (Cont'd.)

Norman Kelley & Co. quarry operated along the south shore from 1869 to 1891 when it was consolidated into the Kelley Island Lime & Transport Co. This structure was probably built between 1872-73 when a total of 16 new houses were constructed by the Calkins and Co. quarry, on the island's north side, and the N. Kelley & Co. quarry on the south side. This was done to accommodate immigrant workers brought in to provide labor for the flourishing limestone trade. Initially, the N. Kelley quarry attracted a predominantly Irish labor force. However, after 1900 the KILT Co. south quarry complex was predominantly Italian. Between 1910 and 1930 this house was occupied by the Feyedelem (See ERI-1716), and later, the Pujallil families. The buildings had cistern water and no electricity. There is some suggestion that these and similar buildings were brought over from the mainland in sections and bolted together in place. This has not been substantiated.

44. (Cont'd.)

company house (ERI-1716) and south of an early lime kiln (ERI-1533) and horse barn (see ER-338). The setting is now wooded and landscaped. Originally it was situated near the brink of the quarry wall where an access road passed to the north and the narrow gauge railroad grade lay along its west flank. Now access is from Cameron Rd., but continues to front to the lane running north to the home of Joseph Feyedelem (ERI-1716).

SEE ADDENDUM FOR ADDITIONAL/CORRECTED INFORMATION

Ohio Historic Preservation Office
1995 Verne Avenue
Columbus, Ohio 43211
(614) 486-1500

OHIO HISTORIC INVENTORY

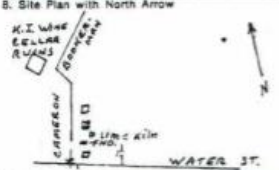
1. No. ERI-1533		4. Present Name(s) Sticklorath Residence		1. No. ERI-1533
2. County ERIE		5. Other Name(s)		
3. Location of Negatives C.H.S.		KIL&T Co. Worker's House		
8. Specific Location East side of Cameron Rd., just north of old lime kiln ruins		16. Thematic Category Ethnic, Manufacturing		2. County ERIE
7. City or Town If Rural, Township & Vicinity Kelley's Island, Ohio		17. Date(s) or Period 1890, remodeled 1965		
6. Site Plan with North Arrow 		18. Style or Design Vernacular		
9. U.T.M. Reference Zone Easting Northing 17 3561300 4606410		19. Architect or Engineer		4. Present Name(s) Sticklorath Residence
10. Site Building Structure Object Site <input checked="" type="checkbox"/> Building <input checked="" type="checkbox"/> Structure <input type="checkbox"/> Object <input type="checkbox"/>		20. Contractor or Builder		
11. On National Register? Yes <input type="checkbox"/> No <input checked="" type="checkbox"/>		21. Original Use, if apparent Quarry residence		
12. Is it Eligible? Yes <input type="checkbox"/> No <input checked="" type="checkbox"/>		22. Present Use Residence		5. Other Name(s) KIL&T Co. Worker's House
13. Part of Etab. Yes <input type="checkbox"/> No <input checked="" type="checkbox"/>		23. Ownership Public <input type="checkbox"/> Private <input checked="" type="checkbox"/>		
14. District Potent? Yes <input type="checkbox"/> No <input checked="" type="checkbox"/>		24. Owner's Name & Address, if known Sticklorath		
15. Name of Established District N/A		25. Open to Public? Yes <input type="checkbox"/> No <input checked="" type="checkbox"/>		Sticklorath Residence
42. Further Description of Important Features (Continue on reverse if necessary) This 1½ story, side-gabled house fits somewhere between the hall- and-parlor and I-house folk traditions. Original elements include some 6/6, double-hung windows. A shed roof addition on the north gable wall (probably built by the KIL & T Co.) and a screened, shed roof on the western eave wall, obscure the original structure. A similar house, once stood about 30' northwest of this building.		26. Local Contact Person or Organization Kevin Pape: KIL Hist. Survey		
43. History and Significance This house, located near the south quarry complex, was rented by a number of immigrant quarry workers. The first known family was that of Joseph Feyelelem, a Hungarian immigrant who came to the island in 1902 to work for the KIL&T Co. as a carpenter. They lived here until c. 1908 when they moved to another company house, #54, further south, and now owned		27. Other Surveys in Which Included N/A		
44. Description of Environment and Outbuildings The house is situated on fill built up to provide access to an old lime kiln. A door in its east wall opens to a sheer drop to the quarry below. Hardly visible from the road, the house is surrounded by dense growth of		40. Visible from Public Road? Yes <input checked="" type="checkbox"/> No <input type="checkbox"/>		Sticklorath Residence
45. Source of Information 1924 Insurance Engineer Map Oral Hist: Angeline Bonchi Joseph and Ray Feyelelem		41. Distance from and Frontage on Road 100' 1.52a.		
46. Prepared by Betty Pape & Kevin Pape		47. Organization KI Planning Comm		
48. Date 9/85		49. Revision Date(s)		

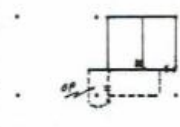

<p>50. House Type No. _____</p> <p>Code No. _____ Name _____</p> <hr/> <p>51. Historic Outbuildings and Dependencies</p> <p>Barn Type(s)</p> <p>Code No. _____ Type _____</p> <hr/> <p>Corn Crib or Shed <input type="checkbox"/> Smoke House <input type="checkbox"/> Privy <input type="checkbox"/> Silo <input type="checkbox"/> Spring House <input type="checkbox"/> Carriage House <input type="checkbox"/> Summer Kitchen <input type="checkbox"/> or Ice House <input type="checkbox"/></p> <p>Other _____</p> <hr/> <p>52. Archaeological Site on Property?</p> <p>Yes <input type="checkbox"/> No <input type="checkbox"/></p> <p style="text-align: center;">Basis for Information</p> <p>Owner Collection <input type="checkbox"/> Above Ground Earthworks or Mound <input type="checkbox"/> Cultural Materials Noted <input type="checkbox"/> CAI No. _____</p>	<p>53. Farmstead Plan</p>  <hr/> <p>54. Photo</p> <p>Roll No. <u>18</u> Picture No(s) <u>34-36</u></p>
---	--

42. (Cont'd)

43. (Cont'd.)

by grandson, Michael Feyedelelem (ERI-1531), and lastly to #55 (ERI-1716) where his son Joseph, Jr. now resides. Other later quarry workers to live here were Sabatinis c 1920, and Adam and Josephine Bianchi who later moved to #61 (ERI-1713). Their son, Nick, (ERI-1587) was born in this Sticklorath house.

OHIO HISTORIC INVENTORY

1. No. ERI-1534		4. Present Name(s) Chigger Hollow		1. No. ERI-1534
2. County ERIE		5. Other Name(s) KIL&T Co. House		
3. Location of Negatives U.S.S.				
6. Specific Location East side of Cameron Rd., last house north of Water Street, 1150'		18. Thematic Category Ethnic, manufact.		2. County ERIE
7. City or Town If Rural, Township & Vicinity Kelleys Island, Ohio		17. Date(s) or Period c.1900		
8. Site Plan with North Arrow K.J. WINTER RUI MS CAMERON RD. BROOKLET man. St. WATER ST.		19. Style or Design Vernacular		
9. U.T.M. Reference 17 356290 4606480		20. Contractor or Builder		4. Present Name(s) Chigger Hollow
10. One Easting Northing Site Building Structure Object		21. Original Use, if apparent Company house		
11. On National Register? Yes <input type="checkbox"/> No <input checked="" type="checkbox"/>		22. Present Use Residence		
12. Is it Eligible? Yes <input type="checkbox"/> No <input checked="" type="checkbox"/>		23. Ownership Public <input type="checkbox"/> Private <input checked="" type="checkbox"/>		5. Other Name(s) KIL&T Co. House
13. Part of Estab. Yes <input type="checkbox"/> No <input checked="" type="checkbox"/>		24. Owner's Name & Address, if known Marshall and Sandra Bockerman, Kelleys Island, Ohio		
14. District Potent? Yes <input checked="" type="checkbox"/> No <input type="checkbox"/>		25. Open to Public? Yes <input type="checkbox"/> No <input checked="" type="checkbox"/>		
15. Name of Established District N/A		26. Local Contact Person or Organization Kevin Pape: KIHist Survey		House
		27. Other Surveys in Which Included N/A		
42. Further Description of Important Features (Continue on reverse if necessary) In the last several years, this home has been extensively remodeled so that none of the exterior elevations or the interior plan exhibit original treatments. It was originally used as a laborer's house by the KIL&T Co. and was somewhat similar to other KIL&T Co. properties in the area, eg., ERI-1531.		43. History and Significance This is one of a number of small houses built by the KIL&T Co. for its quarry workers in the late 1920's. It is not shown on the 1924 Insurance Engineer's map of that company's holdings. In the 1920's an immigrant family by the name of Barolak lived here. They were one of a group of foreign workers that shared a plot of land now occupied by the Post Office		
44. Description of Environment and Outbuildings Perched on the edge of excavated quarry land on 3 sides, the house sits above the road. On the south side is an access grade to the quarry floor. Being an early quarry area, the floor is now silted over and green.		45. Sources of Information 1924 Insurance Engineer's Map Oral Hist: Angelina Bonchi Joseph and Ray Feyedelem Sandra & Marshall Bockerman		
		46. Prepared by Betty Pape & Kevin Pape 47. Organization KI Planning Comm. 48. Date 10/85		

50. House Type No.

Code No. Name

51. Historic Outbuildings and Dependencies

Barn Type(s)

Code No. Type

Corn Crib or Shed ☐Silo ☐Summer Kitchen ☐Smoke House ☐

Spring House

or Ice House

Privy ☐Carriage House ☐

Other

52. Archaeological Site on Property?

Yes ☐No ☐

Basis for Information

Owner Collection ☐Above Ground Earthworks or Mound ☐Cultural Materials Noted ☐

CAI No.

53. Farmstead Plan



54. Photo

Roll No. 12

Picture No(s) 142

42. (Cont'd)

43. (Cont'd.)

and Electric Co-op where they raised potatoes. Pete and his wife, emigrated from Czechoslovakia in 1898 to work for the quarry. They and their two children and a boarder, George Danschie, who emigrated with them are listed in this vicinity in 1910, but little else is known of the family.

Ohio Historic Preservation Office

1985 Verra Avenue
Columbus, Ohio 43211
614-466-1500

OHIO HISTORIC INVENTORY

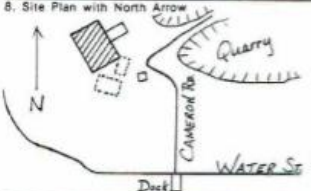
1. No. ERI-1535		4. Present Name(s) Kelley Island Wine Company Ruins		1. No. ERI-1535
2. County ERIE		5. Other Name(s)		
3. Location of Negatives O.H.S.				2. County Erie
6. Specific Location In the SW corner of the island and off Cameron Rd., & approx. 2800' NW of Neuman Dock.		16. Thematic Category Manufacturing		
7. City or Town Kelley's Island		17. Date(s) or Period 1871-1872		4. Present Name(s) Kelley Island Wine Company Ruins
8. Site Plan with North Arrow 		18. Style or Design Vernacular		
9. U.T.M. Reference 17 356090 4605730		19. Architect or Engineer -		5. Other Name(s)
10. Zone Eastings Northing Site <input type="checkbox"/> Structure <input type="checkbox"/> Building <input type="checkbox"/> Object <input type="checkbox"/>		20. Contractor or Builder -		
11. On National Register? Yes <input type="checkbox"/> No <input checked="" type="checkbox"/>		21. Original Use, if apparent Winery		6. Other Name(s)
12. Is it Eligible? Yes <input checked="" type="checkbox"/> No <input type="checkbox"/>		22. Present Use Ruins		
13. Part of Estab. Yes <input type="checkbox"/> No <input checked="" type="checkbox"/>		23. Ownership Public <input type="checkbox"/> Private <input checked="" type="checkbox"/>		7. Other Name(s)
14. District Potent? Yes <input checked="" type="checkbox"/> No <input type="checkbox"/>		24. Owner's Name & Address, if known Joseph Feyedelem Kelley's Island, Ohio 43438		
15. Name of Established District N/A		25. Open to Public? Yes <input type="checkbox"/> No <input checked="" type="checkbox"/>		8. Other Name(s)
42. Further Description of Important Features (Continue on reverse if necessary) The winery ruins resemble the ruins of a Medieval castle with its four dominating corner towers still standing. The exterior walls are fairly intact with tower corners and the south face chimneys projecting slightly from the otherwise flush walls. The south face displays a stepped gable flanked by corbelled chimneys with concrete caps. Window and door openings are round arched, with		26. Local Contact Person or Organization Kevin Fape, KI Hist Survey		
43. History and Significance As their reputation for fine grapes grew, islanders realized that their wines of equally fine quality, did not enjoy the same celebrity. To rectify this situation the Kelley Island Wine Company was established as a co-operative venture in 1865. With capital stock of \$100,000 they secured the lease of Charles Carpenter's wine cellar and dock as a temporary facility for the man-		27. Other Surveys in Which Included N/A		9. Other Name(s)
44. Description of Environment and Outbuildings Located in a wooded area north of the ferry dock and near the south rim of the island's west side quarry. Several ridges or seams of limestone are found in the immediate vicinity. The ruins of Charles Carpenter's wine cel-		28. No. of Stories N/A		
45. Sources of Information 1. History of Kelley's Island, Ohio 2. chols, Handy Guide Book to Put-In-Bay, Middle Bass, & Kelley's Island, 1888		29. Basement? Yes <input checked="" type="checkbox"/> No <input type="checkbox"/>		10. Other Name(s)
		30. Foundation Material Sqr'd & crs'd limestone		
		31. Wall Construction Stone bearing wall		11. Other Name(s)
		32. Roof Type & Material N/A		
		33. No. of Bays Front 3 Side 5		12. Other Name(s)
		34. Wall Treatment Cr's'd & squared stone		
		35. Plan Shape Rectang		13. Other Name(s)
		36. Changes (Explain in #42) Addition <input type="checkbox"/> Altered <input type="checkbox"/> Moved <input type="checkbox"/>		
		37. Condition Interior Ruins Exterior Ruins		14. Other Name(s)
		38. Preservation Underway? Yes <input type="checkbox"/> No <input checked="" type="checkbox"/>		
		39. Endangered? Yes <input checked="" type="checkbox"/> No <input type="checkbox"/> By What? Neglect & deterioration		15. Other Name(s)
		40. Visible from Public Road? Yes <input type="checkbox"/> No <input checked="" type="checkbox"/>		
		41. Distance from and Frontage on Road N/A		16. Other Name(s)
		46. Prepared by Kevin Fape & Kyle Johannsen		
		47. Organization KI Planning Commis		17. Other Name(s)
		48. Date 8/85		
		49. Revision Date(s)		18. Other Name(s)

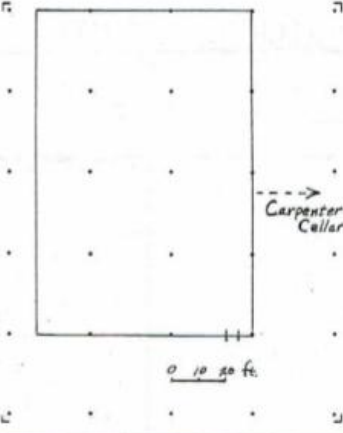
<p>50. House Type No. Code No. Name _____</p> <p>51. Historic Outbuildings and Dependencies Barn Type(s) Code No. Type _____ _____ _____</p> <p>Corn Crib or Shed <input type="checkbox"/> Smoke House <input type="checkbox"/> Privy <input type="checkbox"/> Silo <input type="checkbox"/> Spring House <input type="checkbox"/> Carriage House <input type="checkbox"/> Summer Kitchen <input type="checkbox"/> or Ice House <input type="checkbox"/></p> <p>Other _____</p> <p>52. Archaeological Site on Property? Yes <input type="checkbox"/> No <input type="checkbox"/></p> <p>Basis for Information Owner Collection <input type="checkbox"/> Above Ground Earthworks or Mound <input type="checkbox"/> Cultural Materials Noted <input type="checkbox"/> QAI No. _____</p>	<p>53. Farmstead Plan</p>  <p>54. Photo Roll No. <u>1</u> Picture No(s) <u>17</u></p>
--	--

42. (Cont'd)

round arches above and continuous rough-faced sills below. Wider service entries are topped by segmented arches. The building is set into limestone ridges allowing a first floor service entry on the west end and an entry into the upper cellar level on the east to both be on grade. A wide opening into the lower cellar level, also at grade on the east, may have been a service entry. The cellars themselves are divided into three wine vaults per floor. The round-arched lower vaults are virtually intact while only the walls remain in the overgrown upper cellars. An arched opening and small flight of stairs connects the lower cellars with the adjacent and slightly higher cellar of Charles Carpenter's winery to the north.

43. (Cont'd.)

ufacture and storage of wine pending a larger building. An exceptionally large harvest was expected in 1871 and capital stock was increased to \$300,000 to finance the construction of a new cellar. The wine company built a boarding house on its dock to accommodate the laborers, and construction began July 5th of that year. The 30 laborers were increased to 70 by August 9th and the new building began to take shape. It was located west of the Carpenter Cellar and measured 80x129 feet on the ground. Two floors of cellars were constructed, one above and one below ground, each with three vaults for a total storage capacity of 400,000 gallons. An elegant structure was built over the cellars with a gambrel roof that created a full two stories on the gable ends, with one-and-a-half stories on the long ends. This superstructure contained the superintendent's residence, press rooms, brandy distillery, engine room, and cooper shop.

The year 1871 also inaugurated the production of champagne. Five years later the K.I. Wine Co. was awarded the diploma of highest merit and grand

OHIO HISTORIC INVENTORY

ERI-1535
 ERIE
 O.H.S.

Kelley Island Wine Company Ruins

ERI-1535
 Erie

Kelley Island Wine Company Ruins

#43. (Cont'd.)

medal of honor for champagnes displayed at the Philadelphia Centennial Exposition. Fire destroyed the upper stories of both cellars in 1876. There was a heavy loss with no insurance. New roofs were quickly replaced on the two buildings, but the four steeples that had capped the corner towers were never replaced. The engine room and pressing equipment were reinstalled in the former Carpenter building. By the turn of the century the winery had 15 regular employees and two travelling salesmen. A new distillery was built in 1905, a time when management of the company was still in the hands of islanders. However, by 1909 ownership was transferred to Theophile Netter. During his management the cellar burned again in 1915. The press house, distillery and engine room were consumed but the main building apparently was unharmed. The damaged facilities were restored and operations resumed under limited conditions. During Prohibition (1919-1933), Netter made grape juice and lived in the superintendent's house. On July 29, 1933, the Kelley Island Wine Company burned again, for the last time.

The impressive size and castle-like style of architecture established the Kelley Island Wine Company as a regional landmark. By the late 1880's, storage capacity had climbed to 500,000 gallons, and 1,200 to 1,500 tons of grapes were handled a season, making this winery one of the largest in the Lake Erie Islands region. The company shipped its wines all over the United States and to foreign markets in Canada, Great Britain and Germany. A list of the wines produced by the company in 1885 included: Dry Catawba, Sweet Catawba, Delaware, Elvira, Riesling, Norton's Virginia Seedling, Ives Seedling, Concord, Claret, and Port as well as two champagnes, La Rein de L'isle, and Island Queen. A 1905 list added the sweeter fortified wines: Sherry, Muscatel, and Angelica, along with Carte Blanche Champagne.

#44. (Cont'd.)

lar are adjacent to the north (ERI-1705).

#45. (Cont'd.)

Sandusky Register: Newspaper articles, Frohman Collection, Hayes Presidential Center.
 Courthouse Records
 Oral History: Joseph Feyedalem

Ohio Historic Preservation Office
1985 Ventura Avenue
Columbus, Ohio 43211
614-465-1322

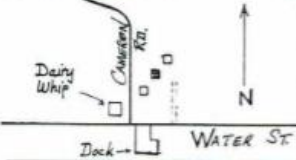

OHIO HISTORIC INVENTORY

1. No. ERI-1536		4. Present Name(s) South Side Lime Kiln	
2. County ERIE		5. Other Name(s)	
3. Location of Negatives O.H.S.			
6. Specific Location On hill above east side of Cameron, just south of Sticklorath House		16. Thematic Category Manufacturing	
7. City or Town If Rural, Township & Vicinity Kelleys Island, Ohio		17. Date(s) or Period c. 1855	
8. Site Plan with North Arrow 		18. Style or Design Draw Kiln, Limestone	
		19. Architect or Engineer Andrew Cameron	
		20. Contractor or Builder Andrew Cameron	
		21. Original Use, if apparent Lime Kiln	
		22. Present Use Ruin	
		23. Ownership Public <input type="checkbox"/> Private <input type="checkbox"/>	
9. U.T.M. Reference 17 356280 46 06380		24. Owner's Name & Address, if known	
10. Building <input checked="" type="checkbox"/> Site <input type="checkbox"/> Structure <input type="checkbox"/> Object <input type="checkbox"/>		25. Open to Public? Yes <input checked="" type="checkbox"/> No <input type="checkbox"/>	
11. On National Register? Yes <input type="checkbox"/> No <input checked="" type="checkbox"/>		26. Local Contact Person or Organization Kevin Pape: KI.Hist.Survey	
12. Is it Eligible? Yes <input checked="" type="checkbox"/> No <input type="checkbox"/>		27. Other Surveys in Which Included N/A	
13. Part of Estab. Yes <input type="checkbox"/> No <input checked="" type="checkbox"/>		28. No. of Stories	
14. District Potenti? Yes <input checked="" type="checkbox"/> No <input type="checkbox"/>		29. Basement? Yes <input type="checkbox"/> No <input checked="" type="checkbox"/>	
15. Name of Established District N/A		30. Foundation Material	
		31. Wall Construction Squared & Crsd. Limest	
		32. Roof Type & Material	
		33. No. of Bays Front Side	
		34. Wall Treatment	
		35. Plan Shape	
		36. Changes (Explain in #42) Addition <input type="checkbox"/> Altered <input type="checkbox"/> Moved <input type="checkbox"/>	
		37. Condition Interior <input type="checkbox"/> Exterior fair	
		38. Preservation Underway? Yes <input type="checkbox"/> No <input checked="" type="checkbox"/>	
		39. Endangered? By What? Yes <input checked="" type="checkbox"/> No <input type="checkbox"/> Deterioration	
		40. Visible from Public Road? Yes <input checked="" type="checkbox"/> No <input type="checkbox"/>	
		41. Distance from and Frontage on Road 100	
42. Further Description of Important Features (Continue on reverse if necessary) This is a draw-type kiln. It is oriented north-south with the loading grade approaching from the north and the lime shoveled out from a door in the southern face. It is square in plan view and tapers, with a step between the upper and lower chambers, from bottom to top. The "pot" is widest at the bottom to insure against choking as the mass descends. Corner blocks are hewn square while interior stones are only roughly shaped. A wrought iron turn buckle encircles the kiln.			
43. History and Significance This is the only extant draw kiln on the island and enjoys a remarkable state of preservation. It represents one of the earliest technologies used to extract a marketable product from the island's limestone resources. It is one of the few surviving elements of the first commercial quarries on the island. In 1855, Andrew Cameron was employed by the island.			
44. Description of Environment and Outbuildings The kiln is located near the working face of the early quarries. Channels for access roads are located just east of the structure. Behind (to the north) the kiln is a vast grade with limestone retaining wall constructed to provide cart access to the loading port. It is one of the few surviving elements of the first commercial quarries on the island.			
45. Sources of Information Bill, History of Kelleys Island, Ohio P. Hamilton Collection, Hayes Presidential Center Mr. Sticklorath, Joe Feydelem			
46. Prepared by Kevin Pape			
47. Organization KI Planning Commis			
48. Date 9/85			
49. Revision Date(s)			

50. House Type No.

Code No. Name

51. Historic Outbuildings and Dependencies

Barn Type(s)

Code No. Type

Corn Crib or Shed ☐ Smoke House ☐ Privy ☐
Silo ☐ Spring House ☐ Carriage House ☐
Summer Kitchen ☐ or Ice House

Other

52. Archaeological Site on Property?

Yes ☒
No ☐

Basis for Information

Owner Collection ☐
Above Ground Earthworks or Mound ☐
Cultural Materials Noted ☐ OAI No. Er339

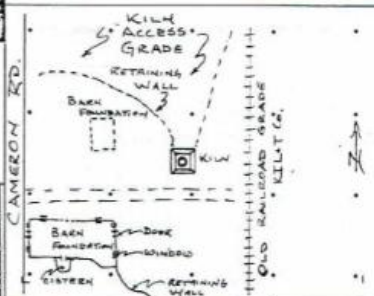
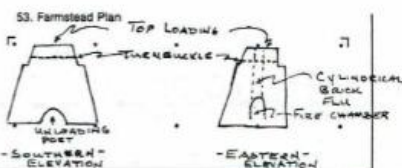

54. Photo

Roll No. 18 Picture No(s) 37-23, 37
23 27

42. (Cont'd)

the upper chamber. Besides the open top used for loading, there are three apertures in the kiln. At ground level, in the center of the southern face, is the unloading port. It is constructed of limestone with a rear wall of fire brick. It has deep, straight sides and is capped with a keystone arch. On the eastern and western sides are single, arched fire brick chambers (now almost totally obscured by slump from the loading grade). These fire chambers are near the bottom of the pot and constructed such that the stone was never directly above the fire but reached by the blaze drawing in from the sides.

43. (Cont'd)

George Kelley to enlarge the "Upper" quarry (see Er339 and Er340). He accomplished this by building a dock (now the Ferry dock) and laying out a road from it to the quarry (now Cameron/Bookerman Rd.). He also constructed this kiln from which lime was burned and shipped (see also ERI-1669). From this beginning, the quarry evolved through the tenure of both the Norman Kelley Co. and the Kelley Island Lime & Transport Co. (Er338). Barns and maintenance buildings of the Norman Kelley Co. were constructed nearby and company housing for the KIL&T Co. was built on the upper loading grade. It was during this later use of the area that the kiln was partially filled in (to reduce the danger of children falling in). One source indicates that this kiln was operated by A.D. Noble of Detroit in 1888; but no records of this firm have been documented, to date.

44. (Cont'd)

is on this grade that the later KIL&T Co. housing was built (see ERI-1533). The foundation of the Norman Kelley Co. draft horse barn is just southwest of the kiln. The grade used by the narrow gauge railroad of the KIL&T Co. to provide access to the coal dock runs between the kiln and Cameron/Bookerman Rd. Oral history indicates that a bridge once spanned this grade.

OHIO HISTORIC INVENTORY

1. No. ERI-1537		4. Present Name(s) Lewis Carver Residence		1. No. ERI-1537 2. County Erie 3. Location of Negatives C.H.S.
2. County Erie		5. Other Name(s)		
3. Location of Negatives C.H.S.		KIL&T Co. Quarry Worker's House #49		
6. Specific Location West side of unimproved rd. to village dump, 150 ft. south of KIL&T Co. Shops		16. Thematic Category Industry, ethnic		28. No. of Stories 2
7. City or Town Kelleys Island		17. Date(s) or Period		29. Basement? <input type="checkbox"/> Yes <input checked="" type="checkbox"/> No
8. Site Plan with North Arrow 		18. Style or Design		30. Foundation Material Molded concrete block
9. U.T.M. Reference Zone 17 Easting 356770 Northing 4607220		19. Architect or Engineer		31. Wall Construction Wood frame
10. Site <input type="checkbox"/> Building <input checked="" type="checkbox"/> Structure <input type="checkbox"/> Object <input type="checkbox"/>		20. Contractor or Builder		32. Roof Type & Material Gable/asph shingle
11. On National Register? <input type="checkbox"/> Yes <input checked="" type="checkbox"/> No		21. Original Use, if apparent Residence		33. No. of Bays Front Side
12. Is it Eligible? <input type="checkbox"/> Yes <input checked="" type="checkbox"/> No		22. Present Use Residence		34. Wall Treatment Asbestos siding ov bevel bd.
13. Part of Estab. Yes <input type="checkbox"/> No <input checked="" type="checkbox"/> Hist. Dist.? <input type="checkbox"/> Yes <input checked="" type="checkbox"/> No <input type="checkbox"/>		23. Ownership Public <input type="checkbox"/> Private <input checked="" type="checkbox"/>		35. Plan Shape Rectangular
14. District Potent? <input type="checkbox"/> Yes <input checked="" type="checkbox"/> No <input type="checkbox"/>		24. Owner's Name & Address. Lewis & Mary C. Carver 1801 West 52nd St. Cleveland, Ohio		36. Changes (Explain in #42) Addition <input type="checkbox"/> Altered <input type="checkbox"/> Moved <input checked="" type="checkbox"/>
15. Name of Established District N/A		25. Open to Public? <input type="checkbox"/> Yes <input checked="" type="checkbox"/> No		37. Condition Interior Fair Exterior Fair
26. Local Contact Person or Organization Kevin Pape: KI Hist Survey		27. Other Surveys in Which Included N/A		38. Preservation Underway? <input type="checkbox"/> Yes <input checked="" type="checkbox"/> No
28. Further Description of Important Features (Continue on reverse if necessary)		39. Endangered? <input type="checkbox"/> Yes <input checked="" type="checkbox"/> No		40. Visible from Public Road? <input type="checkbox"/> Yes <input checked="" type="checkbox"/> No
43. History and Significance This is one of a number of houses that were moved by the KIL&T Co. when the land on which they sat was taken for quarrying. They were then moved from their various locations to the West Bay quarry area to serve as quarters for the quarry workers. At the time of peak operation of this area there were at least five other houses along this road that paralleled the road on which this and the other quarry worker's houses sat is now almost obliterated in weeds and rubble. Only one other house is still standing, obscured by underbrush and in poor condition. The maintenance		44. Description of Environment and Outbuildings		41. Distance from and Frontage on Road 20'
45. Sources of Information Lewis Carver Jake Martin, Joseph Feyedelem Sanborn Insurance Map, 1930		46. Prepared By Kevin Pape		47. Organization KI planning Commis
		48. Date 5/85		49. Revision Date(s)

Photo

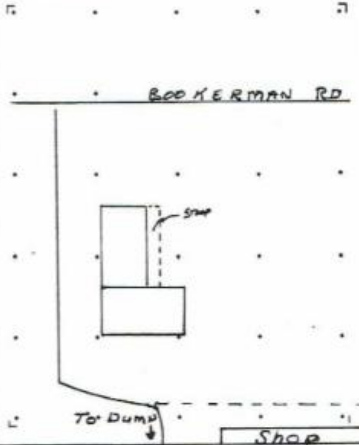
<p>50. House Type No. Code No. Name _____</p> <hr/> <p>51. Historic Outbuildings and Dependencies</p> <p>Barn Type(s) Code No. Type _____</p> <hr/> <p> Corn Crib or Shed <input type="checkbox"/> Smoke House <input type="checkbox"/> Privy <input type="checkbox"/> Silo <input type="checkbox"/> Spring House <input type="checkbox"/> Carriage House <input type="checkbox"/> Summer Kitchen <input type="checkbox"/> or Ice House <input type="checkbox"/> </p> <p>Other: _____</p> <hr/> <p>52. Archaeological Site on Property?</p> <p>Yes <input type="checkbox"/> No <input type="checkbox"/></p> <p style="text-align: center;">Basis for Information</p> <p> Owner Collection <input type="checkbox"/> Above Ground Earthworks or Mound <input type="checkbox"/> Cultural Materials Noted <input type="checkbox"/> OAI No. _____ </p>	<p>53. Farmstead Plan</p>  <hr/> <p> 54. Photo 21 27 Roll No. 23 Picture No(s) 29 </p>
---	--

43. (Cont'd.)

quarry maintenance shops westward.

An historic photograph of this house suggests a house once located near the West Bay at the former end of Cameron Road. This is further supported by an oral report that indicated this house was moved from a hill north of Bookerman Rd. that once marked the island's highest ground, but was leveled by quarrying c.1913-15. The historic owner or date of construction is not known. It is known to have been occupied by the Mervo family in the 20's.

44. (Cont'd.)

shops are closed and boarded. Piles of quarry stones and miscellaneous rubble are scattered about the grounds surrounding the shops. The present house has only recently been opened after years of standing empty and neglected. Its lawn has been cleared and mowed, and restoration is in progress.

SEE ADDENDUM FOR ADDITIONAL/CORRECTED INFORMATION

Ohio Historic Preservation Office
1565 Verna Avenue
Columbus, Ohio 43211
614-456-1500

OHIO HISTORIC INVENTORY

1. No. ERI-1539		4. Present Name(s) West Bay Maintenance Shops		1. No. ERI-1539	
2. County ERIE		5. Other Name(s)		2. County Erie	
3. Location of Negatives O.H.S.				4. Present Name(s) West Bay Maintenance Shops	
6. Specific Location East and west of the Dump Rd., about 400' north of Bookerman Rd.		16. Thematic Category Industry		28. No. of Stories 1	
7. City or Town If Rural, Township & Vicinity Kelley's Island,		17. Date(s) or Period c1900-1912		29. Basement? Yes <input type="checkbox"/> No <input checked="" type="checkbox"/>	
8. Site Plan with North Arrow To dump		18. Style or Design Vernacular		30. Foundation Material Limestone	
9. U.T.M. Reference 17 356 700 460 7280		19. Architect or Engineer		31. Wall Construction Concrete	
10. Zone Easting Northing Site <input type="checkbox"/> Building <input type="checkbox"/> Structure <input checked="" type="checkbox"/> Object <input type="checkbox"/>		20. Contractor or Builder		32. Roof Type & Material	
11. On National Register? Yes <input type="checkbox"/> No <input checked="" type="checkbox"/>		21. Original Use, if apparent Maintenance & Repair		33. No. of Bays Side	
12. Is it Eligible? Yes <input type="checkbox"/> No <input checked="" type="checkbox"/>		22. Present Use Vacant		34. Wall Treatment Stn faced cement blk	
13. Part of Estab. Yes <input type="checkbox"/> Hist. Dist. No <input checked="" type="checkbox"/>		23. Ownership Public <input type="checkbox"/> Private <input checked="" type="checkbox"/>		35. Plan Shape Rect.	
14. District Potent? Yes <input type="checkbox"/> No <input checked="" type="checkbox"/>		24. Owner's Name & Address, if known Wellstone Co. Detroit, Mich		36. Changes (Explain in #42) Addition <input type="checkbox"/> Altered <input type="checkbox"/> Moved <input type="checkbox"/>	
15. Name of Established District N/A		25. Open to Public? Yes <input type="checkbox"/> No <input checked="" type="checkbox"/>		37. Condition Interior Fair Exterior Fair	
42. Further Description of Important Features (Continue on reverse if necessary) At one time there were five communicating buildings making up this maintenance complex, consisting of a 160x60' three stall locomotive house, separate car shed and adjacent machine shop-stock room-blacksmith shop with an overall 2880 sq ft. These were all of stone-faced hollow cement block, corrugated iron roof, and one-story in height. Only the machine shop and car shed are extant. North of the locomotive house was a concrete block boiler house and large		26. Local Contact Person or Organization Kevin Page: KI Hist Survey		38. Preservation Underway? Yes <input type="checkbox"/> No <input checked="" type="checkbox"/>	
43. History and Significance These maintenance buildings were once a part of a larger complex that came into being between 1905 and 1918 with the advent of the mechanization of the quarry process, and following the change of focus from lime making to the production of flux stone for the steel mills of the midwest. It was geared to the narrow gauge railroad and the steamshovel, both of which proliferated in this period.		27. Other Surveys in Which Included N/A		39. Endangered? By What? Neglect Yes <input type="checkbox"/> No <input checked="" type="checkbox"/>	
44. Description of Environment and Outbuildings This complex lies on a broad, levelled plain, surrounded by weeds and brush that has overgrown the former quarry area. Piles of screenings lie to the west. The Village dump area is north. Two of the former six houses still can be seen along the unused road track on the southern boundary, and facing the maintenance buildings.		45. Sources of Information Rollins, Burdock, Hunter: Insurance Engineering Report, 1924 Janborn Insurance Map, 1938 Oral Hist: Jos. & Ray Feyedelem		40. Visible from Public Road? See 41. Distance from and Frontage on Road 400'	
46. Prepared by Kevin Page & Betty Page		47. Organization K.I. Planning Commission		48. Date 8/85	
49. Revision Date(s)				5. Other Name(s)	

50. House Type No.

Code No. Name

51. Historic Out-

Barn Type(s)

Code No.

Corn Crib or Shed ☐Smoke House ☐Privy ☐Summer Kitchen ☐Spring House ☐Carriage House ☐Other ☐

52. Archaeological Site on Property?

Yes ☐No ☐

Basis for Information

Owner Collection ☐Above Ground Earthworks or Mound ☐Cultural Materials Noted ☐

GAI No. _____

53. Farmstead Plan

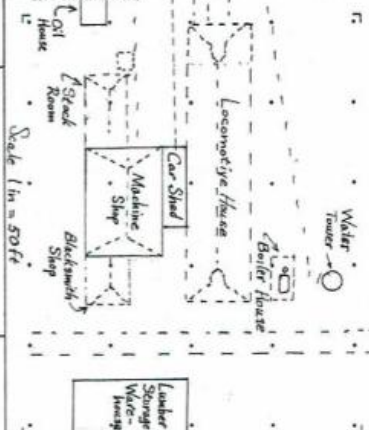

54. Photo

23

30-33

Roll No. 21

Picture No(s) 30-34

42. (Cont'd)

water tank. East of the access road is a 2880 sq' ft' lumber storage shed, one-story, of corrugated iron presently used by its private owner as a warehouse. All windows in the maintenance shop are now blocked with cement blocks. The former stone lug sills are still visible. The large double doored entrance to the shop is of wood plank; the entrance to the car shed on the north is closed with a metal overhead door.

43. (Cont'd.)

The Kelley Island Lime and Transport Co. first introduced the narrow-gauge railroad in 1888 when tracks were laid by the Burt Seymour Engineering Co. of Sandusky, Ohio, and the first locomotives to be used were two of the Lima pattern. There had been two earlier locomotive maintenance facilities at the North Bay. One was a small, two bay shed just south of the crusher bins. The second was similar to the West Bay locomotive house with three bays. Neither of these structures are extant. During the period 1905-1910 the lime kilns and much of the North Quarry operations were phased out. With increased operations on the south side, this large engine terminal was built at a point convenient for working the south and west quarries, and all maintenance facilities were consolidated here.

This was also a period of great expansion of the Lime Co. Production increased, and as many as 21 vessels were loaded in 4 days. 1,546,922 tons of stone were shipped on 460 boats in 1912. Along with its other production centers around the Great Lakes, the KIL&T Company was advertised as the largest business of its kind in the world.

OHIO HISTORIC INVENTORY

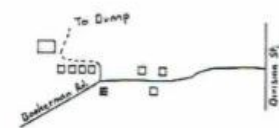
1. No. ERI-1542		4. Present Name(s) Richard and Scotty Zitte	
2. County ERIE		5. Other Name(s)	
3. Location of Negatives U.S.S.		Quarry Store Offices	
6. Specific Location South side of Bookerman Rd. opposite intersection of dunk Rd. with Bookerman		16. Thematic Category Manufacturing	
7. City or Town If Rural, Township & Vicinity Kelley Island, Ohio		17. Date(s) or Period c1900	
8. Site Plan with North Arrow 		18. Style or Design Vernacular	
9. U.T.M. Reference 17 3 5 68 0 0 46 0 7 16 0		19. Architect or Engineer	
10. a. Easting Northing Site <input type="checkbox"/> Structure <input type="checkbox"/> Building <input checked="" type="checkbox"/> Object <input type="checkbox"/>		20. Contractor or Builder	
11. On National Register? Yes <input type="checkbox"/> No <input checked="" type="checkbox"/>		21. Original Use, if apparent Quarry Office	
12. Is it Eligible? Yes <input type="checkbox"/> No <input checked="" type="checkbox"/>		22. Present Use Residence	
13. Part of Estab. Yes <input type="checkbox"/> No <input checked="" type="checkbox"/>		23. Ownership Public <input type="checkbox"/> Private <input checked="" type="checkbox"/>	
14. District Potent? Yes <input type="checkbox"/> No <input checked="" type="checkbox"/>		24. Owner's Name & Address Richard & Scotty Zitte 1405 N. Meade St. Lakeland, Miss. shops	
15. Name of Established District N/A		25. Open to Public? Yes <input type="checkbox"/> No <input checked="" type="checkbox"/>	
42. Further Description of Important Features (Continue on reverse if necessary) This front-gabled building has simple lines and stark detailing limited to narrow frieze and end boards. Windows are 2/2 and, except for the gable end, have vertical board shutters. Front entrance is protected by shed-roofed canopy supported by sawn knee braces. Side entrance is located in rear gabled addition, built continuously with the roof line. The rear addition contains a brick chimney on the gable slope and an external brick flue stack.		26. Local Contact Person or Organization Kevin Pape/KI.Hist.Survey	
43. History and Significance This building originally stood on the shore of the west bay, just south of the limestone loading dock (ERI-1729), and was used by the Kelley Island Lime & Transport Co. c 1900. After its West Bay store and office (ERI-1547) burned in 1921, Superintendent Guerin planned a new and larger replacement, but work was becoming		27. Other Surveys in Which Included N/A	
44. Description of Environment and Outbuildings House is situated near intersection of roads leading to south shore and entrance to KIL&T Co. West Bay shops (See Eri337). Foundation of Reinheimer quarry store, which burned Dec. 25, 1919, is just west of the house. It sits on a mown lot and has exterior cistern.		28. No. of Stories 1	
Sources of Information Oral Hist: Joseph Feyedelem Ray Feyedelem Barbara Coleman		29. Basement? Yes <input type="checkbox"/> No <input checked="" type="checkbox"/>	
		30. Foundation Material limestone rubble	
		31. Wall Construction WOOD frame	
		32. Roof Type & Material Gable/asph. shingle	
		33. No. of Bays Front Side	
		34. Wall Treatment Ship-lapp	
		35. Plan Shape Rec.	
		36. Changes (Explain in #42) Addition <input checked="" type="checkbox"/> Altered <input type="checkbox"/> Moved <input type="checkbox"/>	
		37. Condition Interior Fair Exterior Fair	
		38. Preservation Underway? Yes <input type="checkbox"/> No <input checked="" type="checkbox"/>	
		39. Endangered? By What? Yes <input type="checkbox"/> No <input checked="" type="checkbox"/>	
		40. Visible from Public Road? Yes <input checked="" type="checkbox"/> No <input type="checkbox"/>	
		41. Distance from and Frontage on Road 15	
		46. Prepared by Barbara Coleman	
		47. Organization KI Planning Commis	
		48. Date 9/85	
		49. Revision Date(s)	

50. House Type No.

Code No. Name

51. Historic Outbuildings and Dependencies

Barn Type(s)

Code No. Type

Corn Crib or Shed ☐Silo ☐Summer Kitchen ☐Smoke House ☐Spring House ☐or Ice House ☐Privy ☐Carriage House ☐

Other

52. Archaeological Site on Property?

Yes ☐No ☐

Basis for Information

Owner Collection ☐Above Ground Earthworks or Mound ☐Cultural Materials Noted ☐

QAI No.

53. Farmstead Plan

7



54. Photo

Roll No. 21 Picture No(s) 23-24

42. (Cont'd)

43. (Cont'd.)

slack and funds were not approved by the company's headquarters. So, as an inexpensive substitute this building was moved up to its present site just east of the old office foundations (still visible), and used as the company office until c 1939.

SEE ADDENDUM FOR ADDITIONAL/CORRECTED INFORMATION

Ohio Historic Preservation Office
1985 Vienna Avenue
Columbus, Ohio 43211
614-486-1500

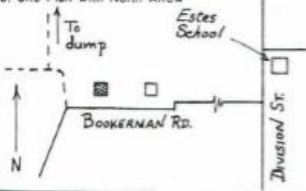

OHIO HISTORIC INVENTORY

1. No. ERI-1543		4. Present Name(s) Palazza Property		1. No. ERI-1543
2. County ERIE		5. Other Name(s)		
3. Location of Negatives O.H.S.		Daniel Huntington House/Daniel Maag House & Winery		2. County Erie
6. Specific Location North side of Bookerman Rd 2200 ft. west of Division St.		16. Thematic Category Agriculture Manufacturing, ethnic C.1866		
7. City or Town If Rural, Township & Vicinity Kelleys Island, Ohio		18. Style or Design Vernacular		4. Present Name(s) Palazza Property
8. Site Plan with North Arrow 		19. Architect or Engineer		
9. U.T.M. Reference Zone Easting Northing 17 35 69 40 46 07 20 0		20. Contractor or Builder		5. Owner Name(s) Daniel Huntington/Dan'l Maag Hs & Wine.
11. On National Register? Yes <input type="checkbox"/> No <input checked="" type="checkbox"/>		21. Original Use, if apparent Residence		
12. Is it Eligible? Yes <input type="checkbox"/> No <input checked="" type="checkbox"/>		22. Present Use Vacant		6. Date 10/85
13. Part of Estab. Yes <input type="checkbox"/> No <input checked="" type="checkbox"/>		23. Ownership Public <input type="checkbox"/> Private <input checked="" type="checkbox"/>		
14. District Yes <input checked="" type="checkbox"/> No <input type="checkbox"/>		24. Owner's Name & Address if known Nancy Palazza, 12841 Cedar, Cleveland, Ohio, 44118		7. Date 10/85
15. Name of Established District N/A		25. Open to Public? Yes <input type="checkbox"/> No <input checked="" type="checkbox"/>		
42. Further Description of Important Features. (Continue on reverse if necessary) The original hall-and-parlor section of this house is identical to ERI-1545. Alterations include a full facade shed porch with square columns and solid balustrade. A large shed addition has been attached to the rear eave wall to expand the living space. Behind it is a continuously roofed shed porch now enclosed. Windows have been replaced with 1/1 types. Trim features,		26. Local Contact Person or Organization Kevin Pape, KI Hist. Survey		8. Date 10/85
43. History and Significance This house was built by Daniel (aka David) Huntington c.1866, on a lot given him by his father, George Huntington (ERI-1698), and identical to the one immediately to the east given to his brother, Erastus. These lots, arranged side by side each had identical hall-and-parlor houses. (See also ERI-1545). Unlike his brother, Erastus, Daniel born on the island in 1845,		27. Other Surveys in Which Included N/A		
44. Description of Environment and Surroundings Quarry cleared land lies to the west. The house lies in open but overgrown fields with vestiges of vine-rows and their wire supports still visible to the northwest. A detached frame garage surrounded by numerous abandoned cars is found at the rear of the house. Behind this the foundations		46. Prepared by Kevin Pape & June Campbell		9. Date 10/85
Sources of Information Jensius Records, Erie Co. 1874 Atlas Map, 1865 Numan Map of KI K.Baker, Hist of KI Grape & Wine Industry, 1965 Virginia Maag Neuman June Campbell, descendant		47. Organization KI Planning Commis		

50. House Type No.
Code No. _____ Name _____

51. Historic Outbuildings and Dependencies
Barn Type(s)
Code No. _____ Type _____ 

Corn Crib or Shed ☐ Smoke House ☐ Privy ☐
 Silo ☐ Spring House ☐ Carriage House ☐
 Summer Kitchen ☐ or Ice House ☐

Other _____

52. Archaeological Site on Property?
Yes ☒
No ☐

Basis for Information
 Owner Collection ☐
 Above Ground Earthworks or Mound ☐
 Cultural Materials Noted ☒ QAI No. _____

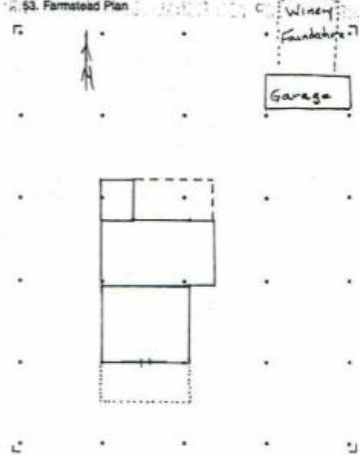
53. Farmstead Plan

54. Photo
 Roll No. 21 Picture No(s) 21 & 22

42. (Cont'd.)
 such as frieze and end boards observed on ERI-1545, are obscured by siding.

43. (Cont'd.)

lived on the island a relatively short time leaving soon after 1880. While here he helped manage his father's estates as a farm overseer, and was appointed Custom's Officer. The house was then purchased by Daniel Maag who had emigrated to the U.S. in 1874 from the Black Sea area of Russia, with other Germans fleeing conscription. He came to the island shortly before 1880 at the instigation of his cousin, August Schaedler (ERI-1654), working for Lewis Beatty and John Ranft in their wineries. His wife, Fredrika Youngman, whom he met in the Dakota Territory became the island midwife. C.1896 they were able to buy their own vineyards and house from Daniel Huntington, and in 1910 build a small winery to the rear of their house. This was one of the many small wineries that were in operation on the island in that period. Daniel and his wife were supporters of the German Evangelical Church and served as a trustee. A son, Elmer, born 1888, worked as a foreman for the Kelley Island Wine Co., living for a time in the superintendent's house over the east cellar, and a second son, William, born 1885, was a plant engineer for the KIL&T Co. Both brothers married daughters of August & Amelia Schnittker in Pittsburgh (See ERI-1568). A daughter, Bertha, born 1884, married quarryman Ralph Heckle. After his death in a quarry accident she lived on in the family home for many years.

44. (Cont'd.)

of the wine cellar and press house are hidden by weeds. A 16'x21' frame shed completes the outbuildings.

OHIO HISTORIC INVENTORY

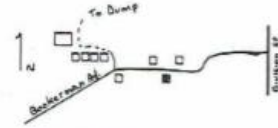
1. No. ERI-1544		4. Present Name(s) Frank Buerkler & Fred Buerkler Residence		1. No. ERI-1544 2. County Er10 4. Present Name(s) Frank Buerkler & Fred Buerkler 5. Other Name(s) Quarry Worker's House # 76
2. County ERIE		5. Other Name(s)		
3. Location of Negatives O.H.S.				
6. Specific Location South side of Bookerman Rd. 600' east from Dump Rd.		16. Formative Category Manufacturing, ethnic		28. No. of Stories 2
7. City or Town If Rural, Township & Vicinity Kelleys Island, Ohio		17. Date(s) or Period c. 1880		29. Basement? Yes <input type="checkbox"/> No <input checked="" type="checkbox"/>
8. Site Plan with North Arrow 		18. Style or Design Vernacular		30. Foundation Material Cement block (See 42)
9. U.T.M. Reference 17 356950 46071140		19. Architect or Engineer -		31. Wall Construction Wood frame
10. On National Register? Yes <input type="checkbox"/> No <input checked="" type="checkbox"/>		20. Contractor or Builder -		32. Roof Type & Material Gable/asph shingle
11. Part of Estab. Yes <input type="checkbox"/> No <input checked="" type="checkbox"/>		21. Original Use, if apparent Residence		33. No. of Bays Side
12. Hist. Dist.? Yes <input type="checkbox"/> No <input checked="" type="checkbox"/>		22. Present Use Residence		34. Wall Treatment Cedar Shake Siding
13. District Potent? Yes <input type="checkbox"/> No <input checked="" type="checkbox"/>		23. Ownership Public <input type="checkbox"/> Private <input checked="" type="checkbox"/>		35. Plan Shape Irreg.
14. Name of Established District N/A		24. Owner's Name & Address, if known Frank and Fred Buerkler		36. Changes (Explain in #42) Added <input type="checkbox"/> Altered <input type="checkbox"/> Moved <input type="checkbox"/>
15. Name of Established District N/A		25. Open to Public? Yes <input type="checkbox"/> No <input checked="" type="checkbox"/>		37. Condition Interior Fair/poor Exterior Fair/poor
16. Local Contact Person or Organization Kevin Pape: KI Hist. Survey		26. Other Surveys in Which Included N/A		38. Preservation Underway? Yes <input type="checkbox"/> No <input checked="" type="checkbox"/>
17. Further Description of Important Features (Continue on reverse if necessary) This house may have been moved from original location by the Kelley Island Lime & Transport Co. It is a side-gabled structure but oriented perpendicularly to the street. Brick chimney is located in peak of gable end. Cedar shingles obscure wall treatment but evidence of beveled siding and a narrow frieze board can be seen. Windows are predominantly 1/1 with half-windows located under eaves. Shed roof addition on rear gable wall covers cistern.		18. Oral Tradition suggests that this house had once been a residence located at the north end of Huntington Rd., and that when the KIL&T Co. vacated that part of the road for quarry purposes this house was moved to its present location and used for quarry worker housing. A house adjacent was moved to Water Street where it is now part of Larry Eaton's Sunset		39. Endangered? Yes <input type="checkbox"/> No <input checked="" type="checkbox"/>
19. Description of Environment and Outbuildings Located near maintenance facilities of KIL&T Co. West Bay Quarry (see Er337), it was one of several nearby company houses. Lot contains many fruit and nut trees also a cow shed southeast of the house, a privy, and a double garage built about 1960.		20. Sources of Information Erney Bugle (deceased) Frank Buerkler Bill & Barbara Coleman Oral Hist: Joseph Feyedelem		40. Visible from Public Road? Yes <input type="checkbox"/> No <input checked="" type="checkbox"/>
21. Prepared by Kevin Pape Barbara Coleman		22. Organization KI Planning Commis		41. Distance from and Frontage on Road 30'
23. Date 8/85		24. Revision Date(s)		42. One Name(s) Quarry Worker's House #76

50. House Type No.

Code No. Name

51. Historic Outbuildings and Dependencies

Barn Type(s)

Code No. Type

Corn Crib or Shed ☐Silo ☐Summer Kitchen ☐Smoke House ☐

Spring House

or Ice House

Privy ☒Carriage House ☐

Other

52. Archaeological Site on Property?

Yes ☐No ☐

Basis for Information

Owner Collection ☐Above Ground Earthworks or Mound ☐Cultural Materials Noted ☐

DAI No.

53. Farmstead Plan



54. Photo



Roll No. 21 Picture No(s) 19-20

42. (Cont'd)

43. (cont'd.)

Point Cottage Rentals. The probable date of the moves would follow the vacating of December 1930. Muntington Road was opened by the County Surveyor in August of 1887 so the probable construction would succeed this date. The Rigis, a quarry worker's family, were known to have lived here.

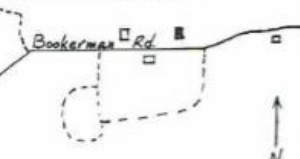
OHIO HISTORIC INVENTORY

1. No. ERI-1545		4. Present Name(s) William Coleman Residence		1. No. ERI-1545
2. County ERIE		5. Other Name(s) Erastus Huntington Residence		
3. Location of Negatives O.H.S.				
6. Specific Location On the north side of Bookerman Rd., 2000' W. of its intersect/Division St.		16. Thematic Category Commerce, Mfg.		2. County ERIE
7. City or Town If Rural, Township & Vicinity Kelleys Island, Ohio		17. Date(s) or Period 1866		
8. Site Plan with North Arrow		18. Style or Design Vernacular Greek Revival		
		19. Architect or Engineer N/A		4. Present Name(s) WILLIAM COLEMAN RESIDENCE
		20. Contractor or Builder N/A		
		21. Original Use, if apparent Residence		
9. U.T.M. Reference		22. Present Use Residence		5. Other Name(s) ERASTUS HUNTINGTON HOUSE
10. Site Building <input checked="" type="checkbox"/> Structure <input type="checkbox"/> Object <input type="checkbox"/>		23. Ownership Public <input type="checkbox"/> Private <input checked="" type="checkbox"/>		
11. On National Register? Yes <input type="checkbox"/> No <input checked="" type="checkbox"/>		24. Owner's Name & Address, if known William & Barbara Coleman - 14916 Arden Ave. Lakewood, Ohio, 44107		
12. Is it Eligible? Yes <input type="checkbox"/> No <input checked="" type="checkbox"/>		25. Open to Public? Yes <input type="checkbox"/> No <input checked="" type="checkbox"/>		
13. Part of Estab. Yes <input type="checkbox"/> No <input checked="" type="checkbox"/>		26. Local Contact Person or Organization Kevin Pape/K.I.Hist.Survey		
14. District Potent(?) Yes <input type="checkbox"/> No <input checked="" type="checkbox"/>		27. Other Surveys in Which Included N/A		
15. Name of Established District N/A		28. No. of Stories 1 1/2		
29. Basement? Yes <input type="checkbox"/> No <input checked="" type="checkbox"/>		30. Foundation Material Coursed rubble		
31. Wall Construction Wood frame		32. Roof Type & Material Cable/asph shingle		
33. No. of Bays Front 3 Side 1		34. Wall Treatment Beveled siding		
35. Plan Shape Rectang.		36. Changes (Explain in #42) Addition <input type="checkbox"/> Altered <input type="checkbox"/> Moved <input type="checkbox"/>		
37. Condition Interior Good Exterior Good		38. Preservation Underway? Yes <input type="checkbox"/> No <input checked="" type="checkbox"/>		
39. Endangered? Yes <input type="checkbox"/> No <input checked="" type="checkbox"/>		40. Visible from Public Road? Yes <input checked="" type="checkbox"/> No <input type="checkbox"/>		
41. Distance from and Frontage on Road 60'/60'		42. Further Description of Important Features (Continue on reverse if necessary)		
<p>A plain narrow frieze board follows beneath the overhanging eave. Second floor windows are double-hung 6/6 lights, while those on the first floor are double-hung 1/1. End boards highlight the building corners. Two early one-story shed-roofed board and batten additions are found in back. A second floor window cut into the backwall and the open front porch are other</p>				
43. History and Significance		<p>Originally, this land belonged to George C. and Emeline Huntington, but in 1861, 10.4 acres were sold to his son, Erastus, then age 22, for \$5.00. The house was built in 1866, three years after Erastus' marriage to Elzina Hamilton, daughter of James Hamilton and Sabra Titus Hamilton.</p>		
44. Description of Environment and Outbuildings		<p>The house sits in a small clearing surrounded by fairly dense woods. A wood frame outhouse and the remains of a probable limestone fruit cellar are found to the rear of the house.</p>		
45. Sources of Information		46. Prepared by Kevin Pape & Kyle Johansen		
Census Records, Erie County Deed and Erie C. Court House Records 1874 Atlas of Erie County Barbara & William Coleman		47. Organization K.I. Planning Comm.		
		48. Date 8/85 49. Revision Date(s)		

Educated at Oberline College, Erastus was a clerk in the general store (The Lodge- ERI-1562) in 1854 until 1866 when he purchased a half interest in the business. The same year he was appointed Postmaster of Kelleys Island, a post which he held until 1884. In 1871 Erastus purchased full interest in The Lodge and his business flourished. By 1876 he had outgrown this residence and built his grand house (ERI-1707) on the south shore. Erastus sold this house to Robert R. Moysey in 1879. Robert Moysey was born in Lincolnshire, England, in 1826, and emigrated to Mansfield, Ohio in 1852. He was a leader in grape, peach, apple, quince, and small fruit growing on the island. Robert Moysey was one of the founders and Treasurer of the Sweet Valley Wine Co. (ERI-1618). His second wife, Susan Snyder, of Pennsylvania, was the island music teacher. Sometime after 1896, the KIL&T Co. owned this residence for laborers in its west quarry; it was house #82. Around 1940, the house was rented to Mathew Kennedy. Born in 1879 to parents of Irish and English birth, Matt was a cooper in the KIL&T Co. north quarry, and lived in a rented house on Huntington Lane before living in this residence after the quarry shut down.

ADDENDUM

CAMERON / BOOKERMAN ROADS

ERI-1533	KILT worker's Hse.	#43 - L3: Feyelem to read "Feyedelem"
1539	West Bay Shops	#53 - Should bear the title heading "Maintenance Shops as shown on the Sanborn Insurance Map of 1905".
1543	Palazza/D. Huntington	#43 - Reverse, L16+17: Both brothers... to read " The brothers married cousins; Elmer marrying Matilda Meier Dickman, and William marrying Minnie Schnittker, daughter of August Schnittker of Pittsburgh. See ERI-1568.